

# WESTMARK

## Baranof Juneau Hotel



*A Holland America Line Company*

The historic Westmark Baranof Hotel is centrally located in downtown Juneau within walking distance of the waterfront, cruise ship docks, shopping, state capitol and government offices. There is complimentary Wi-Fi throughout the hotel.

Guest are welcomed by elegant, art-deco public areas featuring the original artwork of acclaimed Alaska artists Eustace Ziegler and Sydney Laurence.

A delicious gourmet dining experience is offered in the Gold Room Restaurant, and for those in the mood for a cocktail or a craft beer, the lively Bubble Room Lounge will not disappoint. The Capitol Cafe offers an extensive breakfast and lunch menu featuring Southeast Alaskan dishes and generous portions.

Visitors to Juneau can treat themselves to popular attractions including the Mendenhall Glacier, Perseverance Theatre, and Eagle Crest Ski Area.

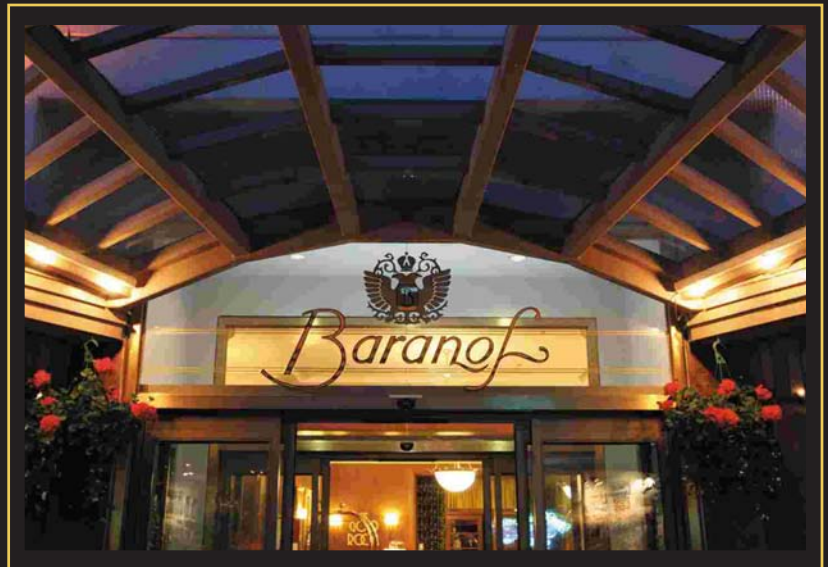

### AMENITIES

Convenient Downtown Location

•  
195 Rooms and Suites

•  
Gold Room Fine Dining, Cafe & Lounge

•  
Banquet/Meeting Rooms

Fitness Center

•  
Channel and Mountain Views

•  
Walk to Historical & Cultural Sites and Cruise Ship Docks

•  
Cable TV

Westmark Baranof Juneau Hotel  
127 North Franklin Street  
Juneau, Alaska 99801-1280

Hotel Telephone: 907-586-2660  
Hotel Fax: 907-586-8315  
Front Office: 907-463-6231

Regional Sales Office: 800-764-0017  
Catering Office: 907-463-6238  
Catering Fax: 907-463-3083

Central Reservations:  
[www.westmarkhotels.com](http://www.westmarkhotels.com)  
800-544-0970

# Westmark Baranof Juneau Hotel

## TREADWELL

SIZE:			CAPACITIES						
DIMENSIONS	SQUARE FEET	CEILING HEIGHT	THEATER	CLASSROOM	CONFERENCE	U-SHAPE	RECEPTION	BANQUET	
44 x 47	2,068	12 FEET	220	112	65	40	300	160	

## AJ ROOM

SIZE:			CAPACITIES						
DIMENSIONS	SQUARE FEET	CEILING HEIGHT	THEATER	CLASSROOM	CONFERENCE	U-SHAPE	RECEPTION	BANQUET	
32 x 16	512	12 FEET	50	24	25	15	70	30	

## GASTINEAU SUITE

SIZE:			CAPACITIES						
DIMENSIONS	SQUARE FEET	CEILING HEIGHT	THEATER	CLASSROOM	CONFERENCE	U-SHAPE	RECEPTION	BANQUET	
42 x 21	882	12 FEET	70	40	30	25	80	40	

## BOARD ROOM 207

SIZE:			CAPACITIES						
DIMENSIONS	SQUARE FEET	CEILING HEIGHT	THEATER	CLASSROOM	CONFERENCE	U-SHAPE	RECEPTION	BANQUET	
15 x 20	300	8 FEET	20	12	12	12	25	12	

## BOARD ROOM 307

SIZE:			CAPACITIES						
DIMENSIONS	SQUARE FEET	CEILING HEIGHT	THEATER	CLASSROOM	CONFERENCE	U-SHAPE	RECEPTION	BANQUET	
15 x 20	300	8 FEET	20	12	12	12	25	12	

## NUGGET ROOM

SIZE:			CAPACITIES						
DIMENSIONS	SQUARE FEET	CEILING HEIGHT	THEATER	CLASSROOM	CONFERENCE	U-SHAPE	RECEPTION	BANQUET	
14 x 24	336	8 FEET	N/A	N/A	18	N/A	25	18	

## DOUGLAS ROOM

SIZE:			CAPACITIES						
DIMENSIONS	SQUARE FEET	CEILING HEIGHT	THEATER	CLASSROOM	CONFERENCE	U-SHAPE	RECEPTION	BANQUET	
44 x 16	704	14 FEET	70	40	30	N/A	80	40	

## TOTAL CONFERENCE CENTER FUNCTION SPACE

SIZE:
SQUARE FEET
5,102

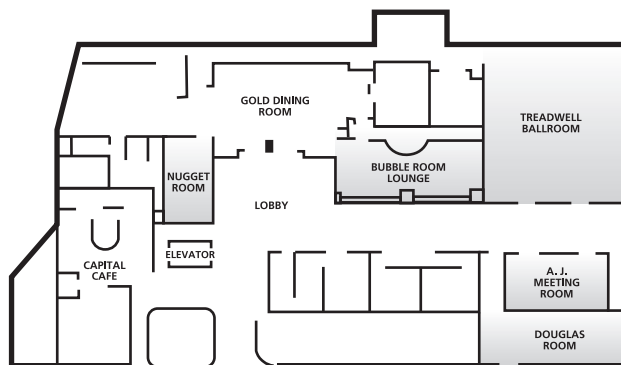

MAIN FLOOR AND LOBBY

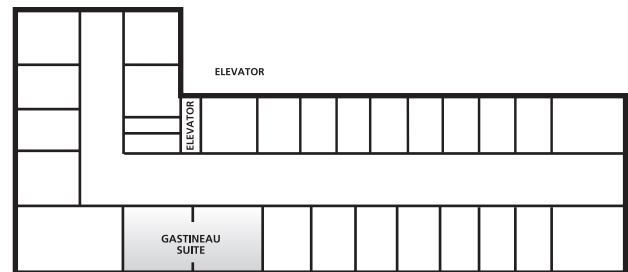

NINTH FLOOR

